

Model LM

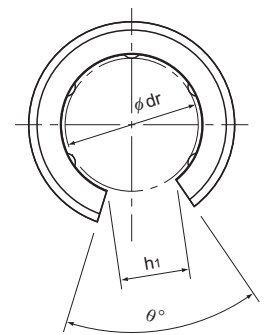
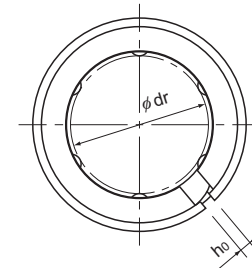
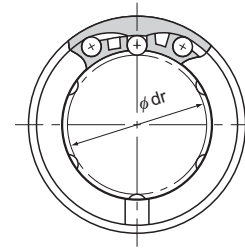
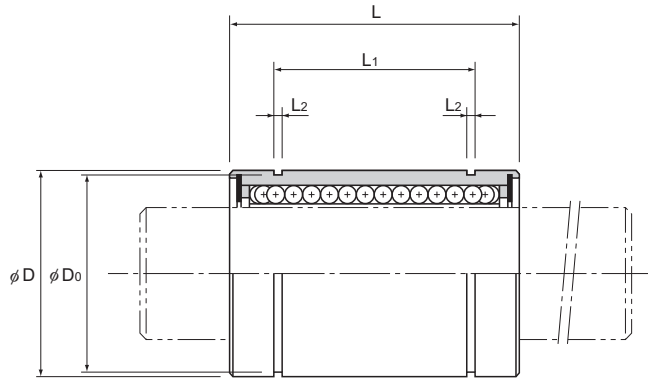

Model LM

Model LM-AJ

Model LM-OP

Unit: mm

| Model No. | | | Ball rows | Main dimensions | | | | | dimensions | | | | | | | Eccentricity (max) μm | | Basic load rating | | | | |
|---------------|---------------------------|-----------|-----------|-------------------------|-----------|----------------|-----------|--------|------------|-------|-----------|-------|-------|-------|-------|----------------------------------|------|-------------------|--|------|---------|--------|
| Standard type | Clearance-adjustable type | Open type | | Inscribed bore diameter | | Outer diameter | | Length | | L_1 | Tolerance | L_2 | D_0 | h_0 | h_1 | θ° | High | Precision | Radial clearance tolerance μm | C N | C_0 N | Mass g |
| | | | | dr | Tolerance | D | Tolerance | L | Tolerance | | | | | | | | | | | | | |
| LM 3 | — | — | 4 | 3 | 7 | 0 | 10 | — | — | — | — | — | — | — | — | 8 | 4 | -2 | 88.2 | 108 | 1.6 | |
| LM 4 | — | — | 4 | 4 | 8 | 0 | 12 | — | — | — | — | — | — | — | — | 8 | 4 | -3 | 88.2 | 127 | 2.2 | |
| LM 5 | — | — | 4 | 5 | 10 | -0.008 | -0.005 | 15 | -0.12 | — | — | — | — | — | — | 8 | 4 | -3 | 167 | 206 | 4 | |
| LM 6 | LM 6-AJ | — | 4 | 6 | 12 | 0 | 19 | 10.2 | 0 | 1.1 | 9.6 | — | — | — | — | 8 | 4 | -3 | 167 | 206 | 4 | |
| LM 8S | LM 8S-AJ | — | 4 | 8 | 15 | 0 | 17 | 13.5 | 0 | 1.1 | 11.5 | 1 | — | — | — | 12 | 8 | -5 | 206 | 265 | 8 | |
| LM 8 | LM 8-AJ | — | 4 | 8 | 15 | -0.011 | 24 | 11.5 | 0 | 1.1 | 14.3 | 1 | — | — | — | 12 | 8 | -5 | 176 | 225 | 9.3 | |
| LM 10 | LM 10-AJ | — | 4 | 10 | 19 | 0 | 29 | 17.5 | 0 | 1.1 | 14.3 | 1 | — | — | — | 12 | 8 | -5 | 265 | 402 | 13.5 | |
| LM 12 | LM 12-AJ | — | 4 | 12 | 21 | -0.009 | -0.006 | 22 | -0.2 | 1.3 | 18 | 1 | — | — | — | 12 | 8 | -5 | 373 | 549 | 25 | |
| LM 13 | LM 13-AJ | LM 13-OP | 4 | 13 | 23 | 0 | 30 | 23 | 0 | 1.3 | 20 | 1.5 | — | — | — | 12 | 8 | -5 | 412 | 598 | 28 | |
| LM 16 | LM 16-AJ | LM 16-OP | 5 | 16 | 28 | -0.013 | 32 | 23 | 0 | 1.3 | 22 | 1.5 | 9 | 80 | 12 | 8 | -7 | 510 | 775 | 38 | | |
| LM 20 | LM 20-AJ | LM 20-OP | 5 | 20 | 32 | 0 | 42 | 26.5 | 0 | 1.6 | 27 | 1.5 | 11 | 60 | 12 | 8 | -7 | 775 | 1180 | 78 | | |
| LM 25 | LM 25-AJ | LM 25-OP | 6 | 25 | 40 | -0.010 | -0.007 | 30.5 | 0 | 1.6 | 30.5 | 1.5 | 11 | 60 | 15 | 10 | -9 | 863 | 1370 | 86 | | |
| LM 30 | LM 30-AJ | LM 30-OP | 6 | 30 | 45 | 0 | 59 | 41 | 0 | 1.85 | 38 | 2 | 12 | 50 | 15 | 10 | -9 | 980 | 1570 | 210 | | |
| LM 35 | LM 35-AJ | LM 35-OP | 6 | 35 | 52 | -0.016 | 64 | 44.5 | 0 | 1.85 | 43 | 2.5 | 15 | 50 | 15 | 10 | -9 | 1570 | 2750 | 221 | | |
| LM 40 | LM 40-AJ | LM 40-OP | 6 | 40 | 60 | 0 | 70 | 49.5 | 0 | 2.1 | 49 | 2.5 | 17 | 50 | 20 | 12 | -13 | 1670 | 3140 | 358 | | |
| LM 50 | LM 50-AJ | LM 50-OP | 6 | 50 | 80 | -0.012 | -0.008 | 60.5 | -0.3 | 2.1 | 57 | 3 | 20 | 50 | 20 | 12 | -13 | 2160 | 4020 | 557 | | |
| LM 60 | LM 60-AJ | LM 60-OP | 6 | 60 | 90 | 0 | 100 | 74 | 0 | 2.6 | 76.5 | 3 | 25 | 50 | 20 | 12 | -13 | 3820 | 7940 | 1418 | | |
| | | | | | | -0.015 | -0.009 | 85 | 0 | 3.15 | 86.5 | 3 | 30 | 50 | 25 | 17 | -16 | 4710 | 10000 | 1733 | | |

Note) Since this model contains a synthetic resin retainer, do not use it at temperature exceeding 80°C.
 If the ambient temperature exceeds 80°C, use the type equipped with a metal retainer (model LM-GA).
 If requiring a type equipped with a seal, indicate it when placing an order.
 (Example) LM13 UU

Note) When using the Linear Bushing on a single shaft, use two or more units (instead of one unit) on the same shaft to avoid a moment load, and secure a large distance between the units.
 If an oil hole is required, this can be indicated by appending "OH" to the end of the model number.
 For further information, contact THK.

Seal attached on both ends of the nut
 For the clearance-adjustable type (-AJ) and open type (-OP), the inscribed bore diameter tolerance, the outer diameter tolerance, and the eccentricity indicate the values before the division of the nut.