

BLK (Rolled Ball Screw) No Preload

DN value 70000

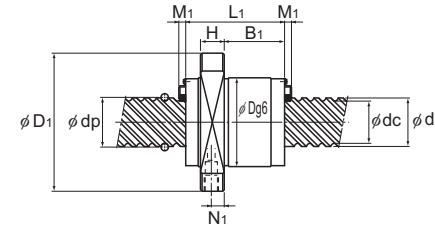
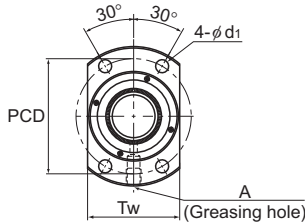

Unit: mm

Model No.	Screw shaft outer diameter d	Lead Ph	Ball center-to-center diameter dp	Thread minor diameter dc	No. of loaded circuits Rows X turns	Basic load rating		Rigidity K N/μm	Nut dimensions				Greasing hole			Seal M ₁	Axial clearance	Standard shaft length	Screw shaft inertial moment/mm ² kg-cm ² /mm	Nut mass kg	Shaft mass kg/m			
						C _a kN	C _{0a} kN		Outer diameter D	Flange diameter D ₁	Overall length L ₁	H	B ₁	PCD	d _i							Tw	N ₁	A
BLK 1510-5.6	15	10	15.75	12.5	2×2.8	9.8	25.2	260	34	57	44	10	24	45	5.5	40	5	M6	3.5	0.1	500, 1000	3.9×10 ⁻⁴	0.26	1.16
BLK 1616-3.6	16	16	16.65	13.7	2×1.8	5.8	12.9	170	32	53	38	10	21.5	42	4.5	38	5	M6	3.5	0.1	500, 1000, 1500	5.05×10 ⁻⁴	0.21	1.35
BLK 1616-7.2	16	16	16.65	13.7	4×1.8	10.5	25.9	340	32	53	38	10	21.5	42	4.5	38	5	M6	3.5	0.1	500, 1000, 1500	5.05×10 ⁻⁴	0.25	1.35
BLK 2020-3.6	20	20	20.75	17.5	2×1.8	7.7	22.3	210	39	62	45	10	27.5	50	5.5	46	5	M6	3.5	0.1	500, 1000, 1500	1.23×10 ⁻³	0.35	2.18
BLK 2020-7.2	20	20	20.75	17.5	4×1.8	13.9	44.6	410	39	62	45	10	27.5	50	5.5	46	5	M6	3.5	0.1	500, 1000, 1500	1.23×10 ⁻³	0.35	2.18
BLK 2525-3.6	25	25	26	21.9	2×1.8	12.1	35	270	47	74	55	12	35	60	6.6	56	6	M6	3.5	0.1	500, 1000, 1500, 2000, 2500	3.01×10 ⁻³	0.64	3.41
BLK 2525-7.2	25	25	26	21.9	4×1.8	21.9	69.9	520	47	74	55	12	35	60	6.6	56	6	M6	3.5	0.1	500, 1000, 1500, 2000, 2500	3.01×10 ⁻³	0.64	3.41
BLK 3232-3.6	32	32	33.25	28.3	2×1.8	17.3	53.9	330	58	92	70	15	45	74	9	68	7.5	M6	3.8	0.14	1000, 1500, 2000, 2500, 3000	8.08×10 ⁻³	1.14	5.69
BLK 3232-7.2	32	32	33.25	28.3	4×1.8	31.3	107.8	650	58	92	70	15	45	74	9	68	7.5	M6	3.8	0.14	1000, 1500, 2000, 2500, 3000	8.08×10 ⁻³	1.14	5.69
BLK 3620-5.6	36	20	37.75	31.2	2×2.8	39.8	121.7	570	70	110	78	17	45	90	11	80	8.5	M6	5	0.17	1000, 1500, 2000, 2500, 3000	1.29×10 ⁻²	1.74	7.09
BLK 3624-5.6	36	24	38	30.7	2×2.8	46.2	137.4	590	75	115	94	18	59	94	11	86	9	M6	5	0.17	1000, 1500, 2000, 2500, 3000	1.29×10 ⁻²	2.42	7.02
BLK 3636-3.6	36	36	37.4	31.7	2×1.8	22.4	70.5	370	66	106	77	17	50	85	11	76	8.5	M6	5	0.17	1000, 1500, 2000, 2500, 3000	1.29×10 ⁻²	1.74	7.12
BLK 3636-7.2	36	36	37.4	31.7	4×1.8	40.6	141.1	730	66	106	77	17	50	85	11	76	8.5	M6	5	0.17	1000, 1500, 2000, 2500, 3000	1.29×10 ⁻²	1.74	7.12
BLK 4040-3.6	40	40	41.75	35.2	2×1.8	28.1	89.8	420	73	114	85	17	56.5	93	11	84	8.5	M6	5.4	0.17	1000, 1500, 2000, 2500, 3000, 4000	1.97×10 ⁻²	2.16	8.76
BLK 4040-7.2	40	40	41.75	35.2	4×1.8	51.1	179.6	810	73	114	85	17	56.5	93	11	84	8.5	M6	5.4	0.17	1000, 1500, 2000, 2500, 3000, 4000	1.97×10 ⁻²	2.16	8.76
BLK 5050-3.6	50	50	52.2	44.1	2×1.8	42.1	140.4	510	90	135	106	20	72	112	14	104	10	M6	5.4	0.2	1000, 1500, 2000, 3000, 4000	4.82×10 ⁻²	3.89	13.79
BLK 5050-7.2	50	50	52.2	44.1	4×1.8	76.3	280.7	1000	90	135	106	20	72	112	14	104	10	M6	5.4	0.2	1000, 1500, 2000, 3000, 4000	4.82×10 ⁻²	3.86	13.79

Note) The overall length of the nut will increase when equipping the QZ lubricating device. See **A15-344** for further details.

Model number coding

BLK3232-3.6 ZZ +1500L C7 T H1K

Model No. Contamination protection accessory symbol (*1) Overall screw shaft length (in mm) Accuracy symbol (*2) Recommended shaft ends shape code Symbol for rolled shaft

(*1) See **A15-336**. (*2) See **A15-12**.